

1556-60/64 Universal Hinge Bracket

Part Number: 11556*

DIRECTIONS

1. Loosely install top hinge. Attachment screws are not included.

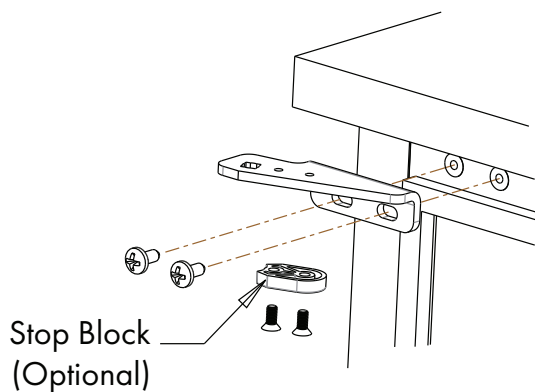

2. Install door to top hinge using wrench.

- Install pivot hinge cartridge (1556-313 or 1556-314) to door and secure with 2 screws
- Use small wrench to rotate pivot hinge 20°
- Once aligned, gently lift the door upward and place into the bracket
- 91556002200095 wrench sold separately

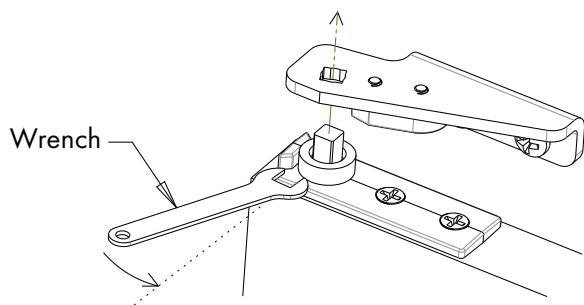

3. Attach lower hinge to cabinet:

- Build lower bracket with pivot pin (2 screws and washers included)
- Install square nylon bushing in the door
- Slide lower bracket assembly in bushing on door and hold in place as door is placed against the cabinet
- Open door 90° and attach bottom hinge bracket with two screws (not included)
- Align door to cabinet and tighten screws

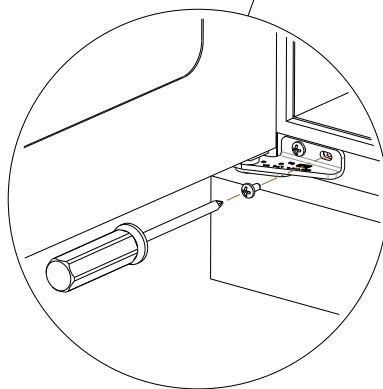
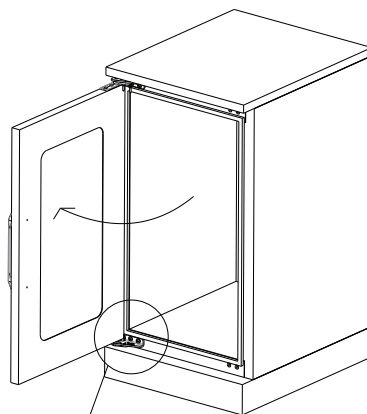
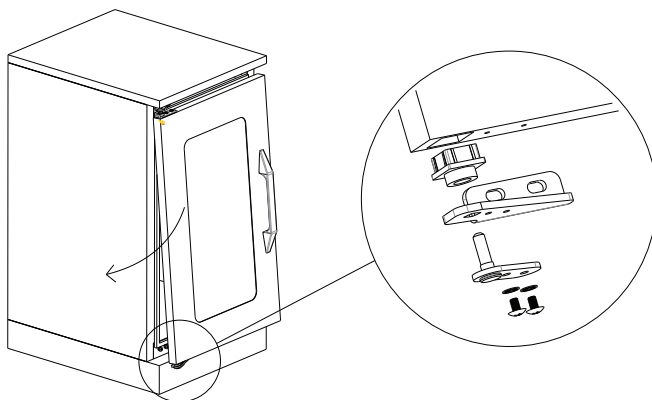

1556-64 Stop Block Kit

